

B.M. Head Wall, Northwest corner of Echo Drive & Del Rosa Avenue
EL 1408.72 M.S.L.

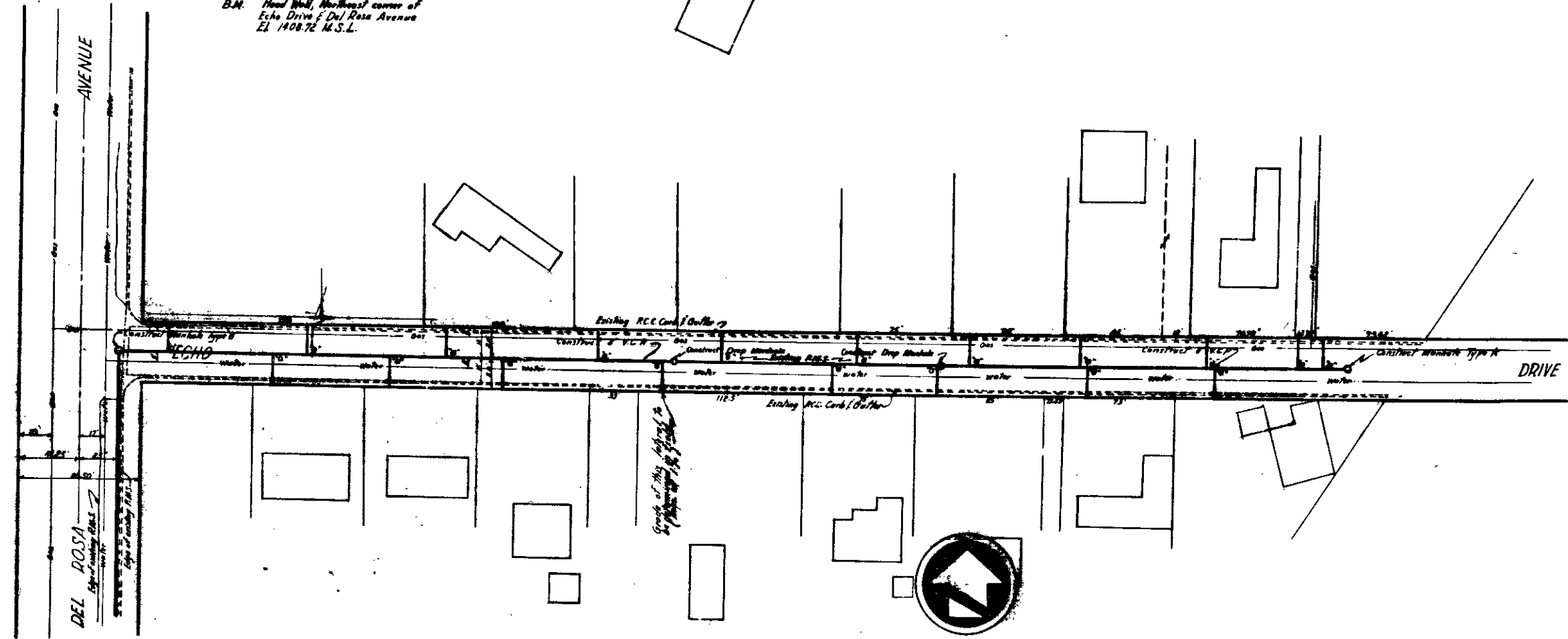

Scale 1"=40'

DEPARTMENT OF ENGINEERING
CITY OF SAN BERNARDINO

DEL ROSA AVENUE Between Echo Drive and a point North of
ECHO DRIVE Between Del Rosa Avenue and Co. Flood
FOOTHILL DRIVE Between Del Rosa Avenue and a point
OSBURN ROAD Between Foothill Drive and a point North
BELMONT COURT Between Osburn Road and a point
MESA VERDE DRIVE East and West of Osburn Road

APPROVED OCTOBER 20 1952
C. W. WILSON
CITY ENGINEER
REGISTERED CIVIL ENGINEER NO. 9222

REFERENCE
DRAWN BY
CHECKED BY